

QUARTIER GÉNÉRAL

Condos Griffintown

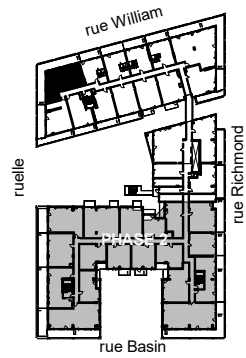

PLAN
E5-ET6

SUPERFICIE PI.CA. - AREA SQ.FT.
783

UNITÉS - UNITS
601



Retombées de plafond / Dropped Ceiling
Préparé | 2019-10-15 / Imprimé | 2020-02-12

* Hauteur libre de 7' - 10" sous le balcon / 7' - 10" clearance under the balcony



01
Séjour
Living Room
10' - 9" x 14' - 4"

02
Cuisine - Salle à manger
Kitchen - Dining Room
11' - 7" / 8' - 4" x 16' - 5"

03
Chambre principale
Master Bedroom
9' - 3" x 9' - 6"

04
Chambre 2
2nd Bedroom
10' - 2" / 7' - 7" x 9' - 10"

05
Salle de bain 1
Master Bathroom
8' - 2" x 5' - 4"

06
Salle de bain 2
2nd Bathroom
8' - 2" x 5' - 4"

07
Walk-in
5' - 10" x 4' - 5"

08
Terrasse
Terrace
35' - 8" / 6' - 10" x 34' - 5" x 6' - 10"

QGgriffintown.ca