

QUARTIER GÉNÉRAL

Condos Griffintown

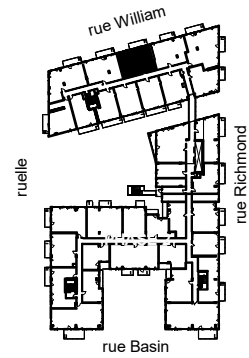

PLAN
D6

SUPERFICIE PI.CA. - AREA SQ.FT.
697

UNITÉS - UNITS
809



Retombées de plafond
Dropped Ceiling

Préparé | 2019-10-15
Imprimé | 2020-02-12



01

Séjour - Salle à manger
Living Room - Dining Room
10' - 7" / 8' - 3" x 20' - 2"

02

Cuisine
Kitchen
9' - 0" x 7' - 6"

03

Chambre Principale
Master Bedroom
8' - 8" x 9' - 4"

04

Chambre 2
2nd Bedroom
8' - 8" x 9' - 8"

05

Salle de bain 1
Master Bathroom
5' - 4" x 8' - 2"

06

Salle de bain 2
2nd Bathroom
5' - 4" x 7' - 6"

07

Walk-in
6' - 2" x 4' - 4"

08

Walk-in
7' - 0" x 4' - 9"

09

Balcon
Balcony
16' - 1" x 5' - 0"

QGgriffintown.ca